

LOAD CELLS

CLA-NA Compression Load Cell 500N~20kN



The CLA-NA Load Cell has a diaphragm type strain sensing element. It is compact, easy to operate and can be used to take consistent measurement.

Protection ratings: IP67 equivalent

Small size
Hermetically sealed

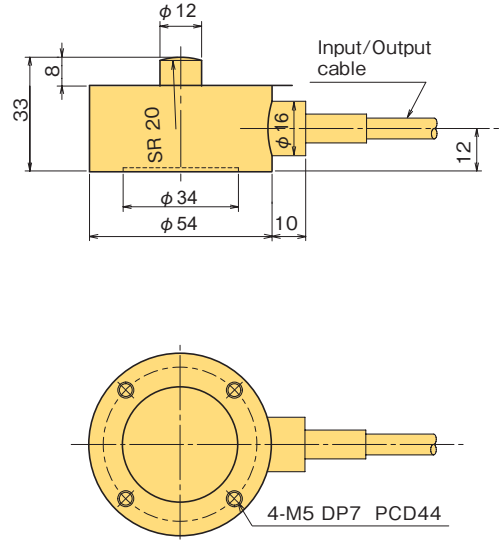

■ FITTING ACCESSORY

TYPE	Spherical Cap FA	Mounting Flange FB	Slide Support FC
CLA-500NA~20KNA	FA-20	FB-2-44	FC-2-20

Refer to pages 35~38 for load cell fitting accessories.

■ SPECIFICATIONS

TYPE	CLA-500NA	CLA-1KNA	CLA-2KNA	CLA-5KNA	CLA-10KNA	CLA-20KNA
Capacity	500N	1kN	2kN	5kN	10kN	20kN
Rated Output	1.5mV/V (3000×10 ⁻⁶ strain) ±0.5%					
Non-linearity	0.2%RO					
Hysteresis	0.1%RO					
Natural frequency	6.1kHz	8.9kHz	13kHz	19kHz	24kHz	28kHz
Temperature effect on zero	0.01%RO/°C					
Temperature effect on span	0.01%/°C					
Compensated temperature range	-10 ~ +60°C					
Allowable temperature range	-20 ~ +70°C					
Over load	150%					
Input/Output resistance	350Ω±2%					
Recommended exciting voltage	6V or less					
Allowable exciting voltage	15V					
Zero balance	5%RO					
Weight	0.36kg					0.38kg

Input/Output cable : φ6mm 0.35mm² 4-core shielded chloroprene cable 5m